

Ribalta "PRISMAtre" per Camera Europea con cremonese "ALBA"

Il kit comprende la ferramenta base (rinvio, incontri, terminali, ecc.) in pressofuso di zama zincata nera, gruppo cerniere superiore e inferiore in zama e alluminio e cremonese, viteria e perni in acciaio inox. La falsamanovra, anch'essa compresa, è posta nella parte superiore del montante verticale appena sotto il rinvio d'angolo. Il kit è disponibile anche nella versione con

manovra logica.

DOTAZIONI

schema di montaggio

"PRISMAtre" kit for tilt and turn for C. E. with "ALBA" cremone

This kit contains the basic hardware (drive, keeps, terminals, etc) made from die-cast black galvanized zamak, hinge unit with an upper and a lower part made from zamak and aluminium, cremone bolt, stainless steel screws and pins.

It is included the incorrect movement safety device, positioned on the upper part of vertical rod, just under the corner drive. Also with logical movement device.

SUPPLIED PARTS

schema di montaggio

art. **24600.00.00**



- scatola da 1 kit
- box with 1 kit

Adattabilità ai sistemi Adaptability to the systems

> ALCAN

Green 45 sormonto, 45/52SP, Keeper 53/60, Keeper 61/68

> AL SISTEM

Planet 45 / 50TT / 62TT / 72HT

> ALL.CO

Export 40 / 45 / 45TT / 50 / 50TT, K45T, K64T, K70T

> ALUMEC

Synthesis 45 / 57 / 60TT

> ALUX SYSTEMS

Shell 50 / 50TH / 60 TH / 70 TH

> ALLU SISTEMI

Twin Systems CX450 / CX600 / CX700

> ETA

Start 410 / 510 / 470TT / 560TT / 640TT

> HYDRO

Break PA52 / PA62 / PA63 / PA70 / PA70S, Bright PA70S, Stopper PG, Stopper PG Style

> INDIINVEST

Gold 400 / 450 / 450TT / 490 / 500 / 600TT

> METRA

NC 45 int. / 45STH / 55 int. / 65STH / 68STH / 72STH

> PASSERINI

Maastricht53 / TH60 / TH68 / TH76 / TH16

> PONZIO

Windstop 45 / 45TT / 45 classic / 55TT / 55TT classic, 65TT / 65TT classic

> PRESAL EXTRUSION

PR50 / PR50TT / PR65TT

> PROFILATI

Eku 40 / 53 / 53TT / 64TT / 72TT

> CAMERA EUROPEA (Euro Groove)

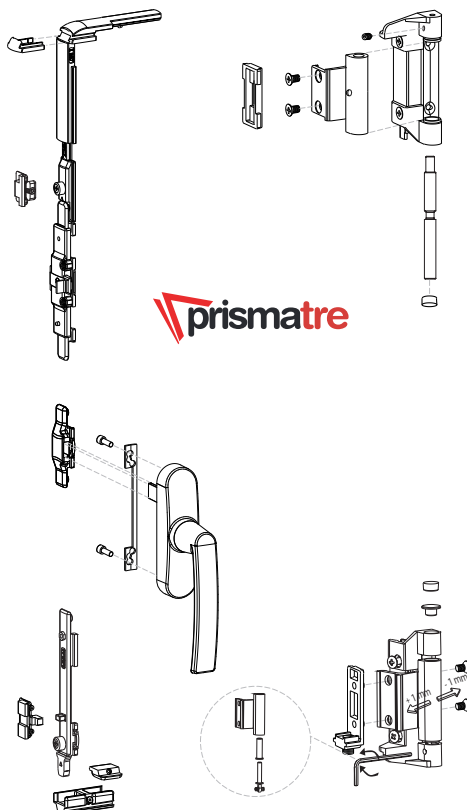

prismatre

